

APPENDIX G

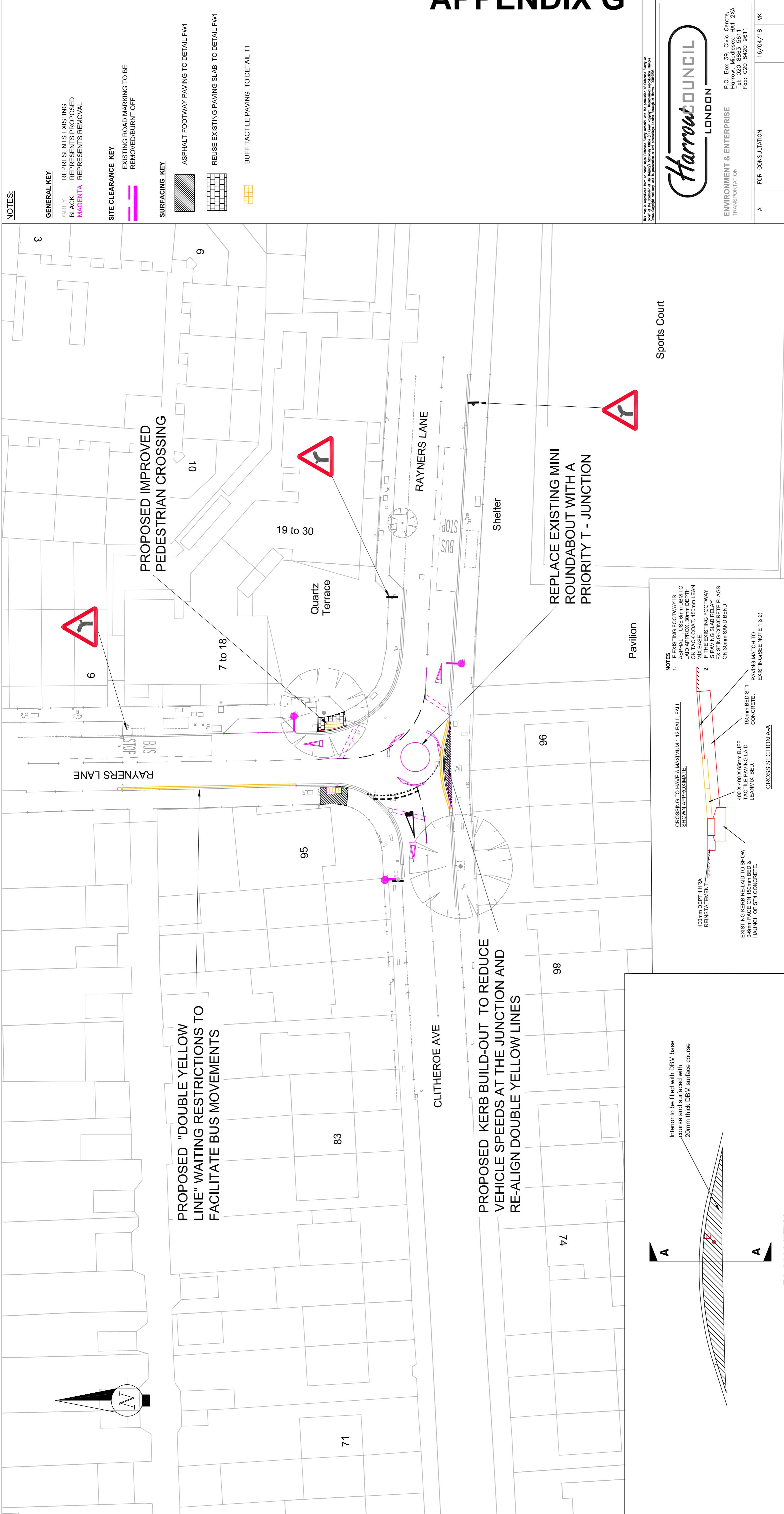

NOTES:

GENERAL KEY
 GREY REPRESENTS EXISTING
 BLACK REPRESENTS PROPOSED
 MAGENTA REPRESENTS REMOVAL

SITE CLEARANCE KEY
 EXISTING ROAD MARKING TO BE REMOVED/BURNT OFF

SURFACING KEY
 ASPHALT FOOTWAY PAVING TO DETAIL FW1
 REUSE EXISTING PAVING SLAB TO DETAIL FW1
 BUFF TACTILE PAVING TO DETAIL T1

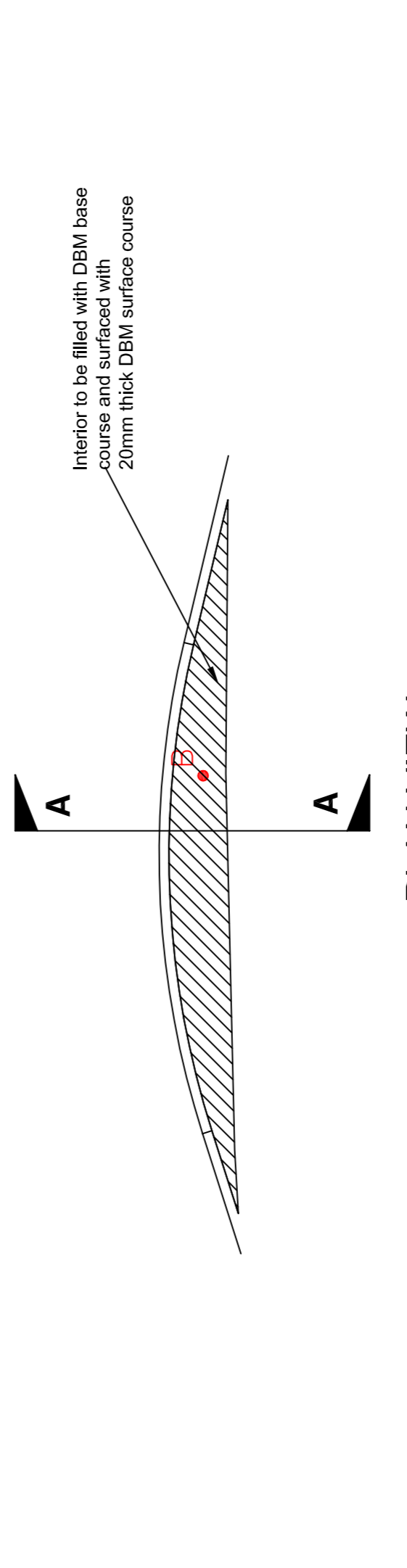
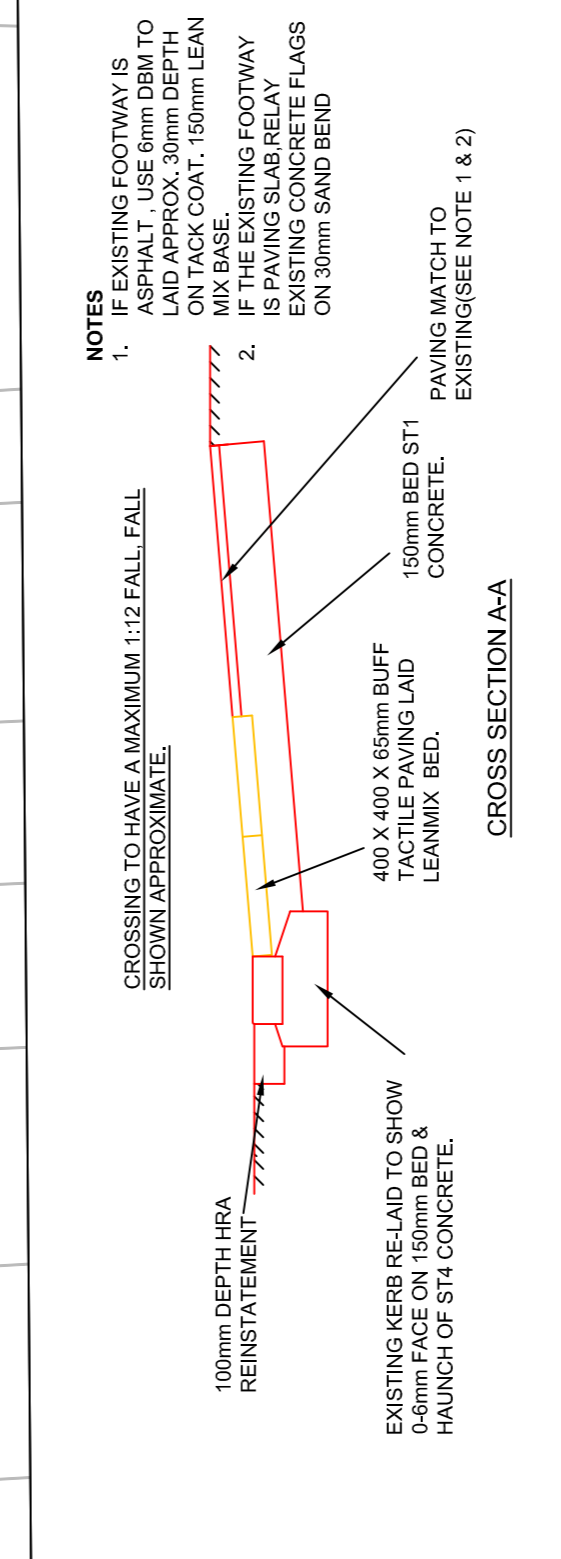

PLAN VIEW

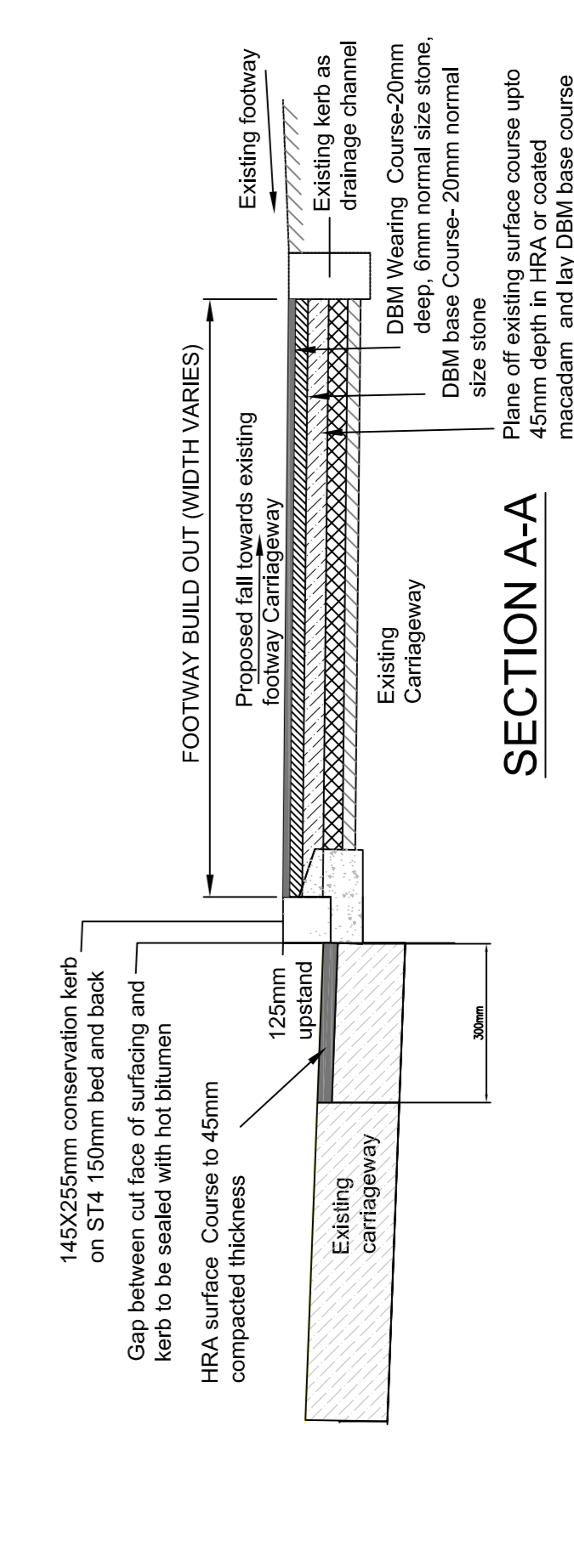

SECTION A-A

**FOOTWAY BUILD OUT
DETAIL FW1**

**SIGN DETAILS
DETAIL TS1**



Sign Reference	512-1R
Height	600mm
Width	679mm
Area *	0.24 m ²
Material	Class RA1 (12899-1:2007)
Mount Height	2300
* Area reduced for rounded corners.	

**ENVIRONMENT & ENTERPRISE
TRANSPORTATION**

P.O. Box 39, Civic Centre,
Harrow, Middlesex, HA1 2JA
Tel: 020 8863 5611
Fax: 020 8420 9611

FOR CONSULTATION

16/04/18

Designation	Details of Revision	Date	Sign
A			

PROJECT INFORMATION

Project: **RAYNERS LANE AND CLITHEROE AVE JUNCTION IMPROVEMENT**

Title: **PROPOSED DESIGN AND STANDARD DETAILS**

Scale: 1:1250
 Drawn: VK
 Date: 16/04/18
 Checked: TP

Drawing no: T/PR/016/18
 Project Name: RAYNERS LANE/CLITHEROE AVE/STANDARD DETAILS
 Autocad file: [blank]
 © HWPC, Project (V06/18) Local Transport Unit scheme (2018-19) Rayners Lane, Clitheroe Ave (2) Drawing